

Battery Back-up Installation/Replacement

WARNING

BE SURE ELECTRICAL POWER HAS BEEN DISCONNECTED FROM THE OPENER PRIOR TO REMOVING THE MOTOR COVER.

WARNING

ANY AND ALL REPAIRS MADE TO THIS UNIT MUST BE PERFORMED WITH THE DOOR DISCONNECTED FROM THE OPENER AND IN THE CLOSED POSITION.

1. Close Door. (If unable to lower door using opener, use extreme caution manually closing door. Before pulling emergency release cord, make certain people and objects are clear of door opening.) Pull emergency release cord down until it latches to close door manually.
2. Unplug opener power cord from power receptacle or turn off breaker.
3. Remove two screws securing bottom cover or existing battery to opener head. Remove cover. FIG. 1. or existing battery backup. FIG. 3.
4. Plug connector of new battery backup into the BBU connection on bottom of opener. FIG. 2.
5. Hold battery backup assembly at a 45 deg. angle to insert rear tabs into slots on bottom of opener. FIG. 3-4.
6. Align battery backup to bottom of opener and secure with two screws removed in step 3.
7. Engage opener to door. Allow battery backup to charge and test. See reverse of this sheet.

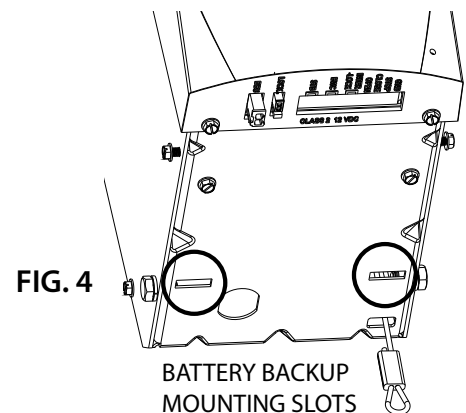
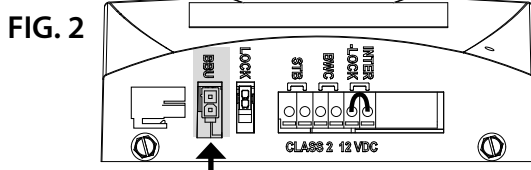
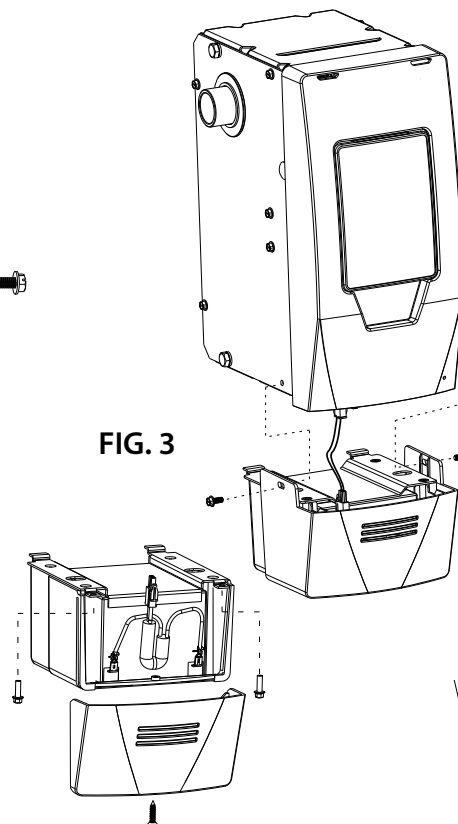
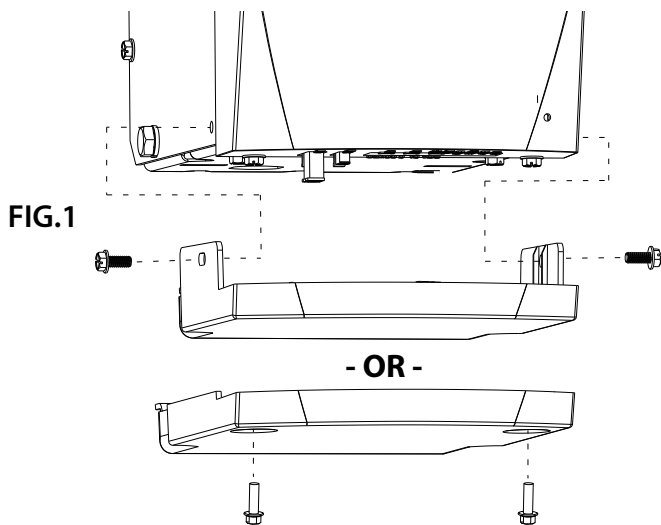

Testing The Battery Backup

NOTE: It is recommended that the battery backup be allowed to charge for 24 to 48 hours prior to testing. Initially, the opener may not operate from the battery backup mode if battery is not fully charged.

1. Run the opener using the wall control or remote to ensure it is working properly.
2. Turn off power to opener by unplugging from outlet or turning off breaker.
3. Press wall control or remote control. Opener will run at a slower speed than normal.

NOTE: See troubleshooting guide in the owners manual if any of the steps above fail.

Work light will not operate while in battery backup mode.

See owners manual for information on LED indicator lights and troubleshooting for the battery backup.

4. After successful test, reconnect power.

OPENER LED SIGNALS with BATTERY BACK-UP installed

LONG LED	ROUND LED	POSSIBLE PROBLEM	SOLUTION
STEADY GREEN	STEADY GREEN	OK= Normal Operation. Charged, Battery Back Up	None Required
FLASHING GREEN	FLASHING GREEN	Discharging, Battery Back Up	Power is out. Battery in use.
FLASHING AMBER	FLASHING AMBER	Charging, Battery Back Up	None Required
FLASHING RED	FLASHING AMBER	Dead Battery, Battery Back Up	Replace Battery.

⚠ CAUTION TO PREVENT POSSIBLE
SERIOUS INJURY or DEATH
from electrocution AND REDUCE RISK of FIRE
— Disconnect ALL electric power sources and battery
power BEFORE performing ANY service or maintenance.
Install only in DRY locations - NOT INTENDED FOR OUTDOOR USE.
Use only 12V,5AH,SLA replacment battery
(P/N 111658.0002.S).

⚠ ATTENTION POUR ÉVITER LES BLESSURES
GRAVES VOIRE MORTELLE PAR
ÉLECTROCUATION POUR RÉDUIRE ES LES RISQUES
D'INCENDIE
— Débrancher toutes les sources d'alimentation électriques et
la pile avant d'effectuer des opérations de réparation ou
d'entretien.
Installer uniquement dans des endroits secs—NE DOIT PAS ÊTRE
UTILISÉ À L'EXTÉRIEUR.
Utiliser uniquement une pile de remplacement de 12V,5AH,SLA
(réf.111658.0002.S).