

# 591

# THERMACORE<sup>®</sup> DOOR SYSTEMS



INSULATED SECTIONAL DOORS



THE BEST SELLING SYSTEM  
IN THE THERMACORE<sup>®</sup> LINE.  
EXCEPTIONAL THERMAL EFFICIENCY  
FOR EXTREME CLIMATIC CONDITIONS.



INDUSTRY LEADING  
COMMERCIAL & INDUSTRIAL SOLUTIONS

## Standard Features at a Glance

### Thermal efficiency

U-factor <sup>1</sup> 	0.13
R-value <sup>2</sup>	14.86 (2.63 K m <sup>2</sup> /W)
Thermal break	PVC
Air infiltration	at 15 mph (24 kmph): .08 cfm/ft <sup>2</sup> (1.46 m <sup>3</sup> /hr/m <sup>2</sup> ) at 25 mph (40 kmph): .08 cfm/ft <sup>2</sup> (1.46 m <sup>3</sup> /hr/m <sup>2</sup> )
IECC®	Meets IECC® requirements for maximum U-factor of operable fenestrations (2015 Section C402.4) with a 3rd party certified tested value of less than 0.37

### Construction

Panel thickness	1 5/8" (41 mm)
Max width	35'2" (10719 mm)
Max height	24'1" (7341 mm)
Exterior steel	.015" (.38 mm) galv.
Exterior surface	Ribbed, textured
Standard springs	10,000 cycle

### Color options

Interior colors	White
Exterior colors	White, Black, Tan, Gray, Industrial Brown

<b>Limited warranty</b>	10-year delamination
	1-year door
	3-year/20,000 cycle door and operator system (material and workmanship)

## Options

- Glazing: Insulated glass, tempered glass, polycarbonate, multi-wall polycarbonate, etc.
- Thermal glazing
- Aluminum sash section available to 24'2" (7366 mm) wide
- Four-section pass door
- High-usage components
- High Performance fluoropolymer coating - (Trinar® or equivalent); White, Brown, Beige
- Wind load options
- Electric operator
- Chain hoist
- Posi-Tension™ drums
- Safety bottom fixtures
- Bottom-sensing edge
- Flexible jamb, header seal
- Exhaust ports



Overhead Door™ Brand participates in the DASMA Thermal Performance Verification Program. The program verifies the thermal performance of sectional doors. The lower the U-factor rating, the better the thermal performance.

 Symbol indicates verified U-factor rating in accordance with the DASMA Thermal Performance Verification Program.

<sup>1</sup> U-factor is a measure of thermal efficiency. The lower the U-factor the greater the insulating properties of the door. U-factor is independently tested and verified per ANSI/DASMA 105 using solid doors and specific product sizes.

<sup>2</sup> R-value is a measure of thermal efficiency. The higher the R-value the greater the insulating properties of the door. Overhead Door Corporation uses a calculated door section R-value for our insulated doors.



**The most thermally efficient door system**

This 1 5/8" (41 mm) thick, steel-polyurethane-steel panel construction, heavy-duty door fits a wide range of opening sizes and the spectrum of applications — making it the best-selling door system in the Thermacore® line and one of the most-specified insulated sectional doors in the industry. Boasting a U-factor of 0.13 and an R-value<sup>2</sup> of 14.86 (2.63 K m<sup>2</sup>/W), one of the best air infiltration ratings, the Thermacore® 591 will meet or exceed almost any thermally efficient application requirement.



Double Thermal Acrylic windows, White finish

**Panel options**

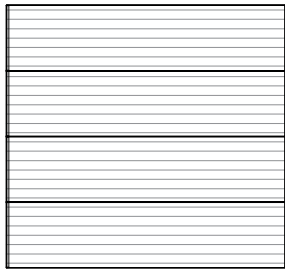

Ribbed, textured panel

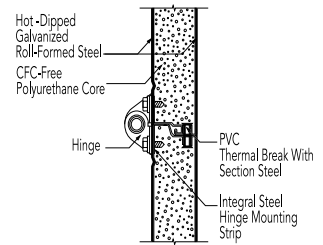
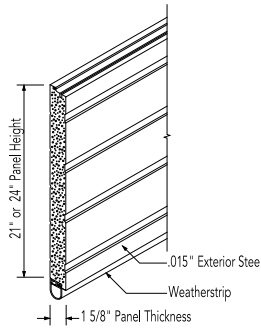

**Color options**

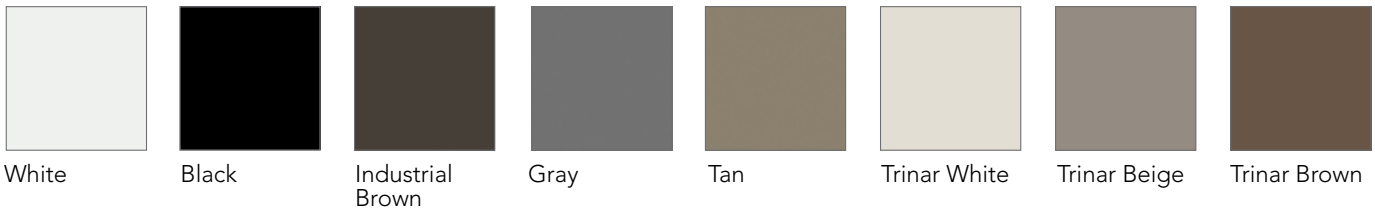

Actual colors may vary slightly from brochure due to fluctuations in the printing process. Ask your Overhead Door™ Distributor for color samples.

**Glazing options**



Double Thermal Acrylic (25" x 12")



Aluminum Sash Section\* with DSB glazing

\*Standard color White

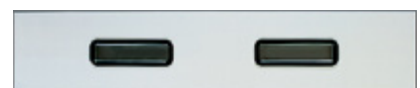

Insulated DSB (24" x 7")



Model 591 Air Force Academy, Colorado Springs.



## Architect's Corner

A resource for architects, containing comprehensive technical and resource materials to support your project, including drawings and specifications for commercial doors.

[overheaddoor.com](http://overheaddoor.com)

### The original, innovative choice for unequalled quality and service.

Overhead Door Corporation pioneered the sectional garage door industry, inventing the first sectional garage door in 1921 and the first electric door operator in 1926. Today, we continue to be the industry leader through the strength of our product innovation, superior craftsmanship and outstanding customer support, underscoring a legacy of quality, expertise and integrity. That's why design and construction professionals specify Overhead Door™ products more often than any other brand. Our family of over 400 Overhead Door™ Distributors across the U.S. and Canada not only share our name and logo, but also our commitment to excellence.



INDUSTRY LEADING  
COMMERCIAL & INDUSTRIAL SOLUTIONS

2501 S. State Hwy. 121 Bus., Suite 200, Lewisville, TX 75067  
1-800-929-DOOR • [sales@overheaddoor.com](mailto:sales@overheaddoor.com)  
[overheaddoor.com](http://overheaddoor.com)